

Star Housing and Certified Properties

(M) : 9419071081, 9906520444

Address (JAMMU): 23 A/C 2nd Floor, Behind Spice, Food Court, Gandhi Nagar, Jammu

Address (Srinagar): 37,38 2nd Floor, Gogji Bagh, Srinagar

Developers :



ADARSH BUILDESTATE LTD.

heavenly bliss with a touch of grace

Disclaimer : Builders and Developers reserve the right to change any design and specification of the building without any prior notice and information. This booklet is for illustration purpose only and it cannot be in any way treated as a legal document. All information, specifications, plans, material and visual representations contained in the booklet, brochure, model & sample flat are subject to change from time to time by the developer and /or the competent authorities and shall not form part of the offer or contract.

stunningly beautiful even if it's
a **glimpse from up above**

Aesthetically designed each floor is an innovative architectural marvel indeed. The floor plans have been thoughtfully conceived so as to enhance the open areas of every unit thus maximizing the flow of air and light. All the towers are designed so as to enjoy the breathtaking beauty of the lush plantation in the pollution free surroundings.

Bird Eye View



CLUB HOUSE



- Snooker
- Modern Gymnasium
- Table Tennis
- Chess
- Carrom
- Playing Card Table
- Entertainment Zone



THE PROJECT

Group Housing of 262 Ultra Luxury Apartments

- 2 BHK / 3 BHK / 4 BHK Luxury Flats with Servant / Store Room
- Ravishing Gardens
- Exclusive Interior
- Fully Furnished Clubhouse
- Elegant Exterior
- Modular Kitchen
- Wooden flooring

Top-of-the-line Assortments

- Elegant Reception Area
- Impressive Waiting Lounge for your Guest
- Children's Play Area
- Ultra Modern Landscapes & Water Cascades
- Ample Open & Covered Car Parking Space

TYPE 1

4 BHK Flat Layout

Sitting with Servant Room

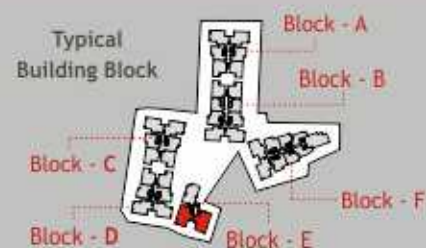

Saleable Area - 2401.00 sq.ft.

TYPE 2

4 BHK Flat Layout

with Servant Room

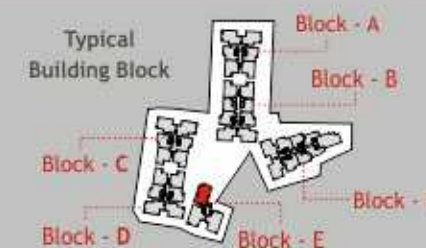

Saleable Area - 2262.00 sq.ft.

TYPE 3

4 BHK Flat Layout with Servant Room

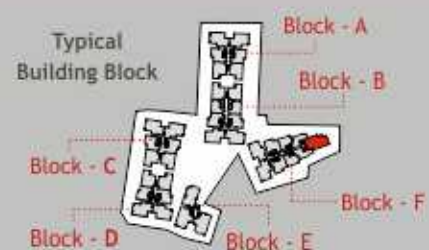

Saleable Area - 2556.00 sq.ft.

TYPE 4

3 BHK Flat Layout Sitting with Servant Room

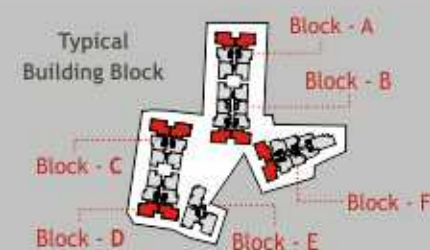

Saleable Area - 2084.00 sq.ft.

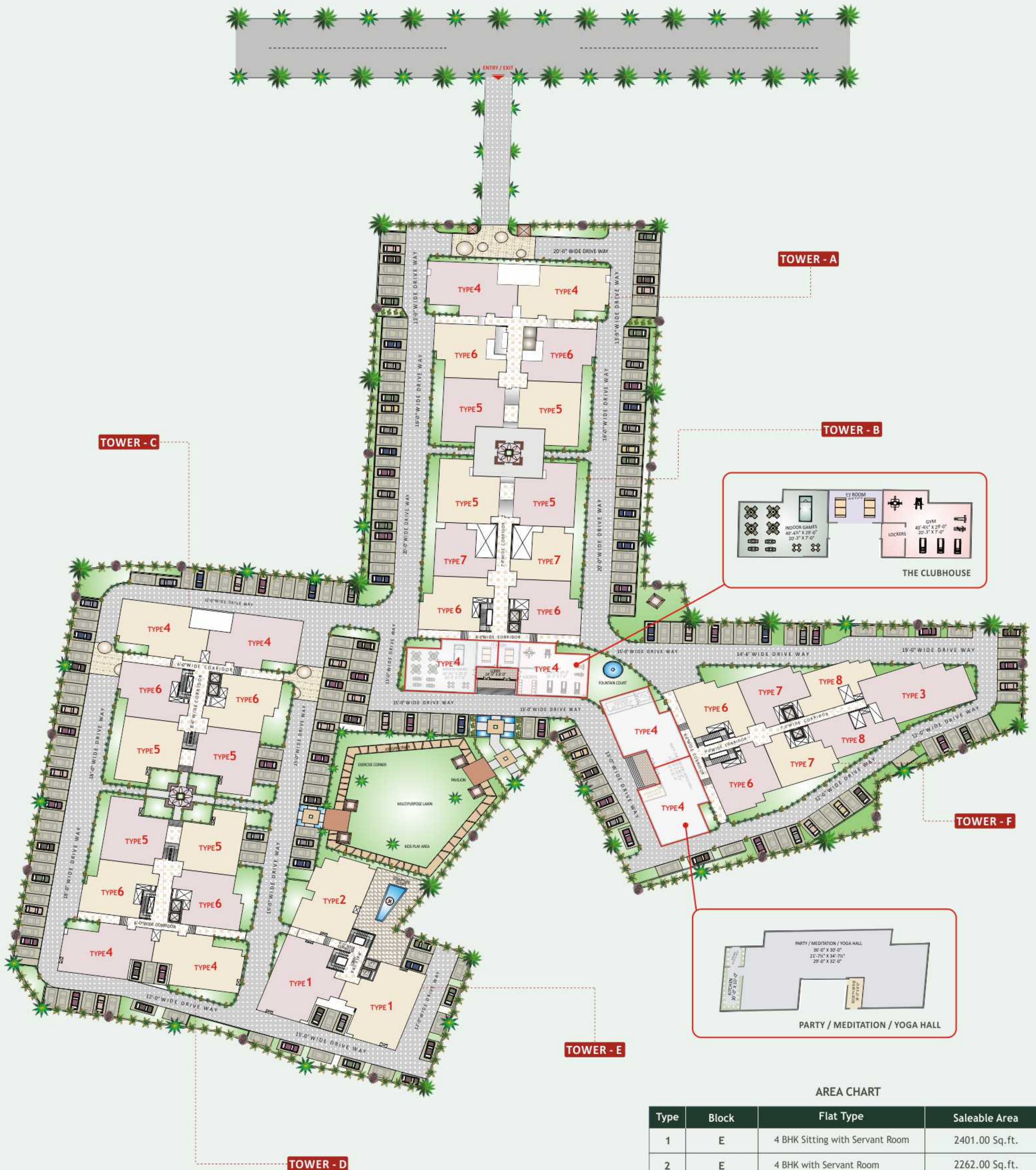

AREA CHART

Type	Block	Flat Type	Saleable Area
1	E	4 BHK Sitting with Servant Room	2401.00 Sq.ft.
2	E	4 BHK with Servant Room	2262.00 Sq.ft.
3	F	4 BHK with Servant Room	2556.00 Sq.ft.
4	A B C D F	3 BHK Sitting with Servant Room	2084.00 Sq.ft.
5	A B C D	3 BHK 3 Toilet with Servant Room	1771.00 Sq.ft.
6	A B C D F	3 BHK with 3 Toilet	1600.00 Sq.ft.
7	B F	2 BHK with 2 Toilet	1268.00 Sq.ft.
8	F	2 BHK 2 Toilet with Store Room	1283.00 Sq.ft.

A calm And Soothing Space - **One Of The Most
Coveted Destinations** is Yours To Be Owned.



It's your very own heaven on earth.

Finely enhanced by all that one seeks in a luxurious lifestyle, **Palm Spring** answers to it all and some more. Bringing alive the prime essentials of contemporary living standards. Optimum usage of space management lends a rare degree of charm to even the simplest of details. Each tower has been thoughtfully designed so as to further enhance the landscaped garden view that can be glimpsed from every apartment of the tower. Broad streets with dense beautiful palm plantations radiate a sense of largeness and spaciousness here.

TYPE 5

3 BHK Flat Layout 3 Toilet with Servant Room

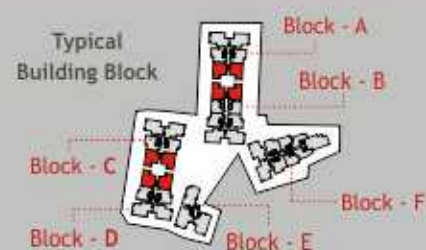

Saleable Area - 1771.00 sq.ft.

TYPE 6

3 BHK Flat Layout with 3 Toilet

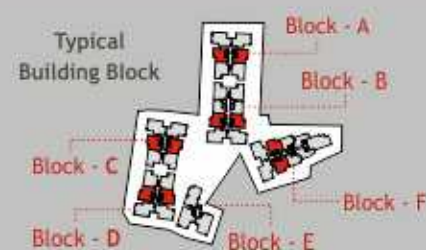

Saleable Area - 1600.00 sq.ft.

TYPE 7

2 BHK Flat Layout with 2 Toilet

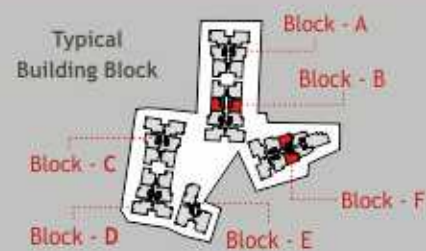

Saleable Area - 1268.00 sq.ft.

TYPE 8

2 BHK Flat Layout 2 Toilet with Store Room

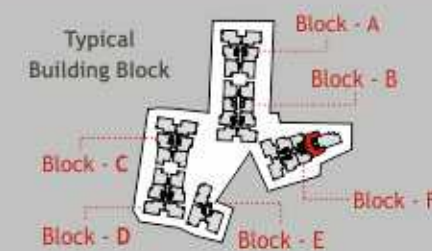

Saleable Area - 1283.00 sq.ft.



An entire gamut of leisure experiences is the perfect backdrop to these luxury residences at Palm Spring that provide world class accessories and stunning views of the valley. What's more, you have access to every possible amenity to ensure your daily routine runs like clockwork. Dedicated 24X7 power supply and a top-notch security service makes it possible to lead a carefree life for you and your loving family.



Project Features

- Earthquake Code Compliant with Building Design to highest codal provisions for this zone.
- Rain Water Harvesting.
- Gated Community.
- Cohesive Urban Design includes road, street furniture, street lighting, paving and signage.
- Water Features within the Development.
- 24/7 and 100% Power backup for common areas & Facilities.
- Concealed electrical wiring with copper conductors and Miniature circuit breakers.
- Cable TV and telephone outlets in living room and bedrooms.
- Wastewater Treatment Plant - state of the Art Membrane Technology for water purification and recycling.
- Laminated wooden flooring in master bedrooms.
- Fitted baths with contemporary modern fittings.
- CCTV and video door phone for surveillance & perimeter security.
- Fire protection system like smoke detectors and fire hydrant cables as per NBC norms.
- Anti-termite treatment for the entire building complex.
- Acrylic emulsion weather proof external paints.
- Provision for Gas Bank (Piped gas supply to individual flats).
- Provision for DTH (Direct to Home) facility.
- Separate car wash area.

Unique Lifestyle Advantages

DELHI

UDAIPUR

JAIPUR

REWARI

DEHRADUN

GURGAON

SRINAGAR

JAMMU

JODHPUR



ADARSH BUILDESTATE LTD.

Envisioning a vision to contribute comprehensively to the altering skyline of the nation, Adarsh Buildestate Ltd. have already made their presence felt with their prestigious projects lined up to make history. Famed in the industry circuits for having a penchant for ushering in global standards of excellence, the group is surging ahead with a multitude of upcoming projects that will give a new definition of fashion & lifestyle.

The ongoing projects have already earned the group an impregnable goodwill for transparent and ethical business practices and coupled with a strong focus on quality, it has already created a legacy of trust that requires no endorsements by its esteemed clientele. Bubbling with a youthful exuberance, the group stands strengthened with a mature team of professional acumen that will guide it to stellar heights, with not just the magnanimity of its projects but also the enthusiasm of its audience clientele.

ushering in global standards of excellence...

OUR PROJECTS



Elements Mall
Commercial, Jaipur



Precious Mall
Commercial, Jaipur



Lake City Mall
Commercial, Udaipur



Palm Island
Commercial, Jammu



Golden Palms
Commercial, Jammu



SKY-25
Residential Group Housing, Jaipur



Sky Terraces
Residential Group Housing,
Jaipur

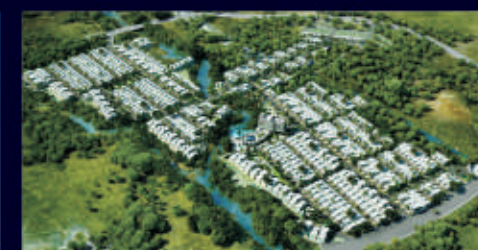

Panache Valley
Residential Township, Dehradun(UA)



Royal Palms
Residential Township, Jammu



Palm Spring
Residential Township, Srinagar



Panache Empire
Residential Township,
Rewari, Haryana



The Kingdom
Residential Township,
Jodhpur

UPCOMING PROJECTS

THE STATUS
Mahaveer Nagar,
Jaipur

ESTANCIA
Durgapura,
Jaipur

MANTRA MEADOWS
Ghaziabad

EMBASSY
Sec-112,
Gurgaon